



DISPENSER

dispenser shrink wrappers



- Ideati per il confezionamento di alimenti come carne, formaggio, pasta, frutta e verdura freschi; i dispenser offrono un servizio veloce e igienico nei supermercati, macellerie e gastronomie in genere, dove il commercio di prodotti freschi richiede un confezionamento giornaliero veloce e sicuro.
- Struttura in acciaio inox.
- Rulli e astine in alluminio anodizzato.
- Taglio del film per mezzo di un filo caldo a bassa tensione per i modelli 40M, 50M2 e 51M.
- Profilo teflonato per i modelli 50MBT e 51MB (non provoca fumo).
- *Designed for packing meat, cheese, pasta, fruits and vegetables; our wrapping machines offer a fast hygienic service for supermarkets, butcher's, delicatessens and wherever fresh products retail needs a quick and safe daily packaging.*
- *Stainless steel body.*
- *Anodized aluminium rollers and rods.*
- *Film cutting by means of a low-voltage heated wire (versions: 40M, 50M2 and 51M)*
- *50MBT0 and 51MB versions with teflon coated section. (do not smoke).*



51 M



1. Particolare filo caldo (1)
Heated cutting tread (1)



2. Profilo teflonato (2)
Teflon-coated section (2)

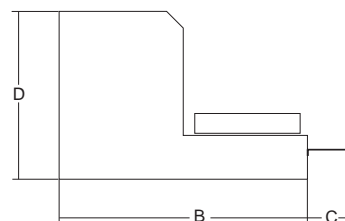
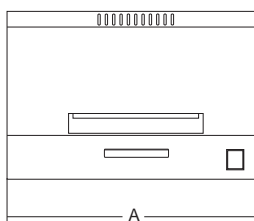

	Potenza Power Spannung Puissance	Alimentazione Power source Betriebsspannung Alimentation	Taglio film Film cutting Folienchnitt Coupe de la pellicule	Rotoli film Max. film roll Folienrollen max Max. bobine film	Piano riscaldante Heating surface Heizfläche Plateau chauffant	A	B	C	D	Peso netto Net weight Nettogewicht Poids net	Dimensioni imballo Shipping Verpack. abmes- surungen Dim. emballage	Peso lordo Gross weight Bruttogewicht Poids brut
	Watt	230V/50Hz	(1)	mm	mm	mm	mm	mm	mm	Kg	mm	kg
40M	115	230V/50Hz	(1)	400	290x165	465	500	125	290	12,5	580x600x370	14
50M2	115	230V/50Hz	(1)	500	290x165	590	540	125	290	14	650x580x370	15,5
50MBT	190	230V/50Hz	(2)	500	290x165	590	500	125	290	14	650x580x370	15,5
51M	115	230V/50Hz	(1)	500	300x175	590	720	130	185	14,5	780x670x270	16
51MB	190	230V/50Hz	(2)	500	300x175	590	720	130	185	14,5	780x670x270	16

Potencia
Potência
Мощность
功率

Alimentación
Alimentação
Электропитание
電源

Corte de película
Corte filme
Вырезывания пленки
薄膜切割

Rotulos película
Bobina película
Рулон пленки макс.
最大薄膜卷

Piano calentador
Plano de aquecido
Подогреваемая поверхность
加热表面

A B C D

Peso neto
Peso líquido
Вес нетто
淨重

Dimensiones embalaje
Dimensões embalagem
Размеры упаковки
包裝尺寸

Peso bruto
Peso bruto
Вес брутто
毛重



51 MB



50 M2



40 M