



PARTS & SERVICE MANUAL

AIR POWERED

MAGNUM '1000' DEHIDER

Patent No.'s 2,974,413 3,165,833 3,358,370 3,468,350 Others Pending

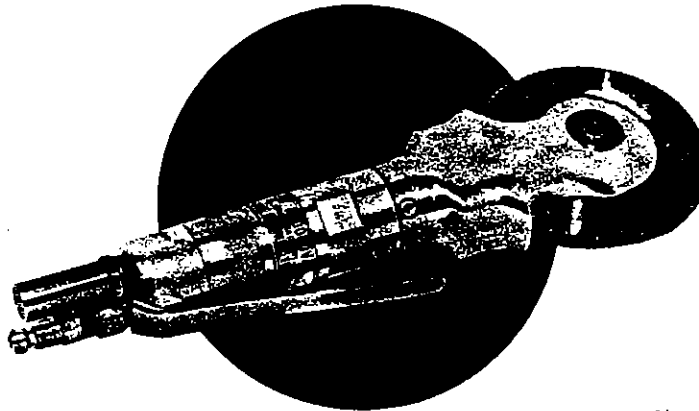

INSTALLATION OPERATING MAINTENANCE INSTRUCTIONS PARTS LIST



BEST & DONOVAN
5570 Creek Road, Cincinnati, OH 45242, USA

TOLL FREE: 1-800-553-2378
TELEPHONE: (513) 791-9180

CABLE: WEPCO
FAX: 513-791-0925

IMPORTANT

Inspect your Best & Donovan Magnum "1000" Dehider for possible damage as soon as you receive it. If you discover any damage, notify carrier's agent at once and request him to inspect the damage, also notify Best & Donovan. Also check the packing list against the contents to be sure you have all parts. If no damage is found, place the Magnum "1000" on a table or bench for connection of hoses, lubrication and test operation before placing it in service on the "kill" floor.

NOTE: Carefully read the following instructions before attempting to assemble and operate your "1000" Dehider.

WARNING

ALWAYS EXERCISE CARE WHEN OPERATING OR PERFORMING MAINTENANCE, REPAIRS AND ADJUSTMENTS. Always disconnect air connector before attempting to work on the tool. Never allow any part of your person or any other person to be in the path of the blade when the machine is in service.

AIR PRESSURE of 90 to 110 pounds per square inch (90-110 p.s.i.) is required for maximum efficiency. If necessary, install a regulator to maintain this range. Pipe and fittings on main supply line should be a minimum of $\frac{3}{8}$ inch. To maintain the best efficiency of this machine, couplers or connectors which have a smaller inside diameter than the supply hose, **SHOULD NOT BE USED.**

WARNING

Whenever you replace the blades or whenever your hands or any part of your person may come in contact with the blades, the tool must be disconnected from service to prevent accidental machine running.

WARNING

If a tooth should break off a blade while the machine is in operation the operator or someone else could be injured. Always inspect blades for fatigue cracks before using.

BEFORE DISASSEMBLING a tool, the area around the work bench should be clean and free from metal chips and other foreign matter. It is a good practice to spread a clean cloth on the work bench to prevent the loss of small parts.

IT IS IMPORTANT that all parts are thoroughly cleaned and inspected before assembling. The slightest particles of dirt can create premature mechanical failures.

MAINTENANCE

Preventative maintenance is the first step of good maintenance. A periodic check should be made to replace worn parts and to inspect lubrication levels. A worn part replaced in time may save extensive repairs later.

THIS IS A PRECISION MACHINE made up of precision parts and should be handled with extreme care. Do not squeeze machine or parts in holding device or otherwise misuse. Too much pressure exerted in holding device may cause distortion of part. Be sure you have the correct tools and fixtures before assembling (or disassembling) this tool.

INSTALLATION AND MAINTENANCE OF B&D AIR POWERED MAGNUM "1000" DEHIDER

INSTALLATION

Connect #6337893 Filter-Regulator-Lubricator unit to air line. Bowl must be kept filled with a #10 good grade oil at all times. A Filter-Regulator-Lubricator unit should be used with each knife. Adjust air pressure to a range of 90 to 110 pounds per square inch. Attach air hose and snap on knife. With knife running, adjust oil for a drop rate of one oil drop every five or six seconds, or $\frac{3}{4}$ to a full bowl per day.

MAINTENANCE

KILL FLOOR

1. Put ten shots of #2111100 grease in fitting in cap at morning break, noon break, and afternoon break.
2. Grease air motor gear case at morning, noon and afternoon breaks, using 6 to 8 shots of grease.
3. Put 3 shots of grease in fitting in 6361300 Alignment Stud at noon break.
4. When changing blades, pack grease around eccentric and in cap that fits over matched bearings.

END OF WORKDAY

1. Remove 6362400 Allen socket screw from 6362300 Bearing Shaft. Unscrew 6361300 Alignment Stud and unscrew #9900552 screw. Remove yokes, blades, and blade spring. Clean thoroughly with solvent.
2. Reassemble. Put grease under blade spring and pack around eccentric. Put grease in cap.
3. Install sharp blades with numbers matched and up.
4. Blades come in serial numbered, matched pairs. Install sharp blades with numbers up. When these become dull, rotate blades 180° to put numbers down.
5. Be sure that 6361300 is only thumb tight. **Do not overtighten.**
6. Put oil in air intake. Blow through motor with air hose.
7. Put six shots of grease in fitting in air motor.

**NEVER LET A WET OR DIRTY KNIFE SET OVERNIGHT WITHOUT CLEANING
PRECISION PARTS WILL BE RUINED.**

END OF WORKDAY — MONDAY, WEDNESDAY AND FRIDAY

1. Fill air intake with solvent and blow through knife with air hose. Repeat.
2. Fill air intake with oil and blow through knife with air hose.

IMPORTANT NOTE

1. Use only clear bearing grease. NEVER use graphite or white grease. B&D Waterproof Grease #2111100 is U.S.D.A. approved. It will not emulsify or melt out in the sterilizers. Experience has proven it to be the best.
2. Do not overtighten 6361300 Alignment Stud.
3. Use only serial numbered pairs of blades together.

WHEN REPAIRS ARE NECESSARY consult drawing containing part, for identification. When ordering repair parts, be sure to list Model Number, Part Number and Part Name to assure prompt and accurate shipment of your order.

MAGNUM "1000" PARTS LIST

PART NO.	DESCRIPTION
6360000	Complete Air Magnum "1000" Dehider
6306100	Roll Pin
6312300	"O" Ring
6361100	Rivet, Short Cap
6361201	Grease Fitting
6361300	Alignment Stud
6361400	Cap
6361500	* End Bushing (2 Req'd)
6361601	* Yoke, Short
6361702	* Blades - Pair 4 $\frac{1}{2}$ " Dia. (107.95mm)
6361703	Blades - Pair 3 $\frac{1}{2}$ " Dia. (88.90mm)
6361801	* Yoke, Long
6362000	* Blade Spring
6362100	Body
6362200	* Set Screw
6362300	* Bearing Shaft
6362400	Allen Socket Screw
6362500	Rivet, Long Body
6362601	* Eccentric
6363000	Gear Case Assembly
6363100	* Idler Gear (2 Req'd)
6363200	* Idler Shaft (2 Req'd)
6363300	Retaining Ring
6363400	* Ball Bearing (2 Req'd)
6363500	Gear Cage
6363600	* Needle Bearing
6363700	Gear Case
6363800	Spline Adapter
6363900	* Front Bearing
6364000	Retaining Ring
6365000	Rotor - Cylinder Assembly
6365100	* Rotor Blade (5 Req'd)
6365200	Retaining Ring
6365300	* Bearing
6365400	Upper End Plate
6365500	Cylinder
6365601	Rotor - 5 Vane
6365700	Lower End Plate
6365800	* Bearing
6365900	Spindle Gear
6366000	Housing
6366100	Key
6367000	Valve Body Assembly
6367100	Throttle Lever
6367200	Bushing
6367300	Valve Stem
6367400	Spring
6367500	Valve Body
6367600	Muffler
6367700	Air Strainer
6367800	Bail
6367900	Bushing (2 Req'd)
8887400	Hose Connector
8887700	Assembly Wrench Complete
9900552	Fillister Head Screw

* Denotes Recommended Spare Parts & Blades

DIAGRAM

Air Motor Assembly



6363000



6365000



6366000

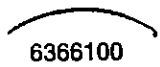

6366100

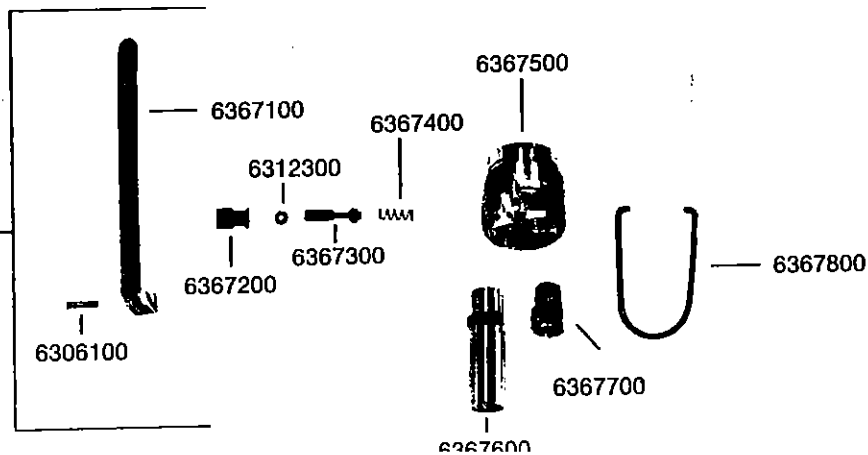
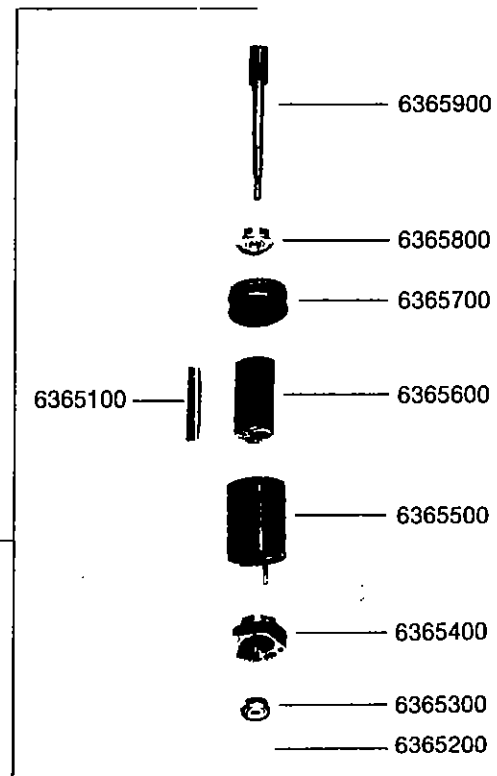
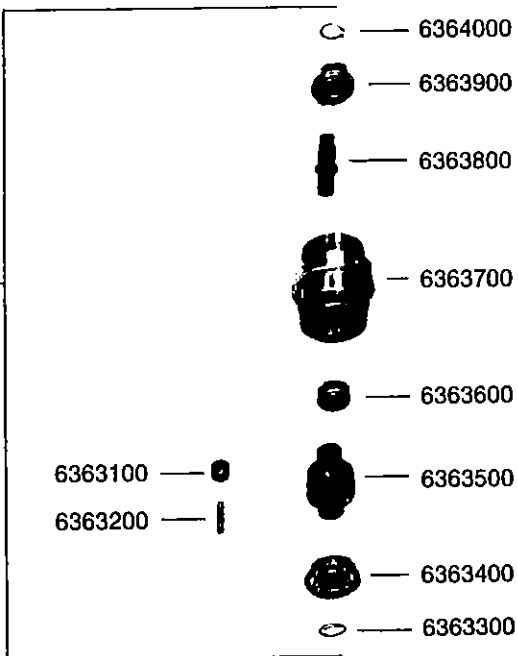
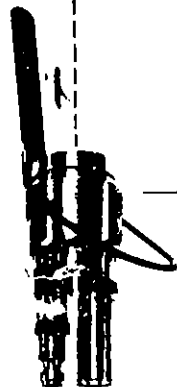

DIAGRAM

Head Assembly

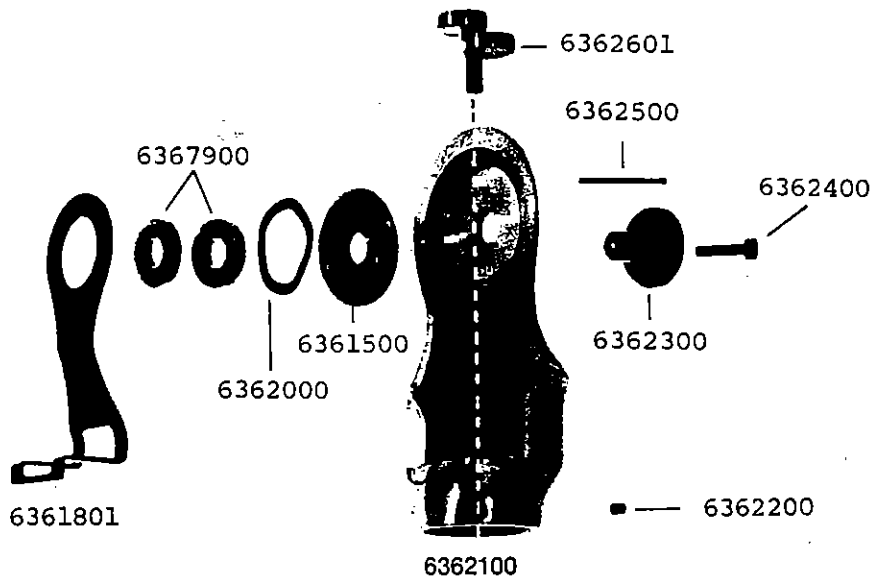
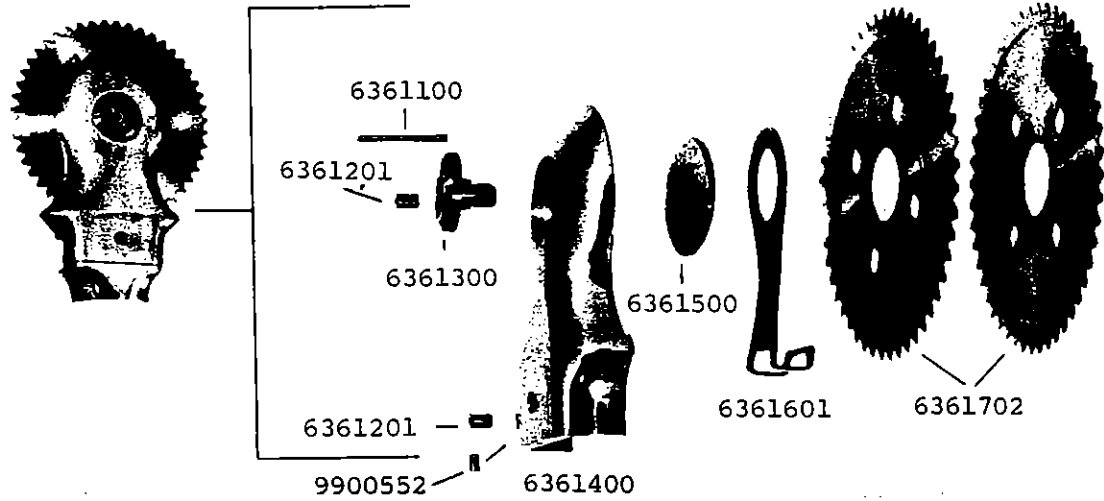

Hose, Fittings and Regulator

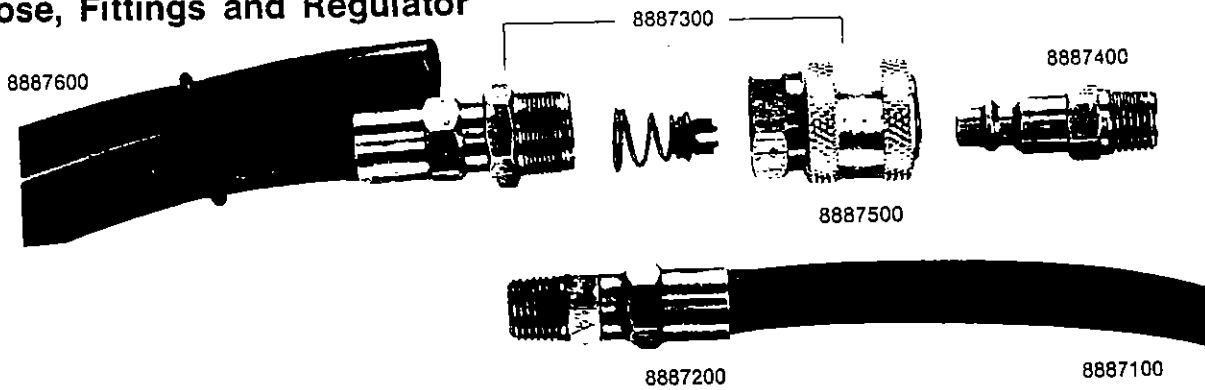

Part Number	Description
8887100	Air hose (16 feet) complete with quick disconnect
8887200	Replacement air hose coupler
8887300	Replacement air hose coupler quick disconnect
8887400	Replacement air hose adapter
8887500	Replacement air hose disconnect
8887600	Exhaust hose
6337893	Filter-Lubricator-Regulator Unit

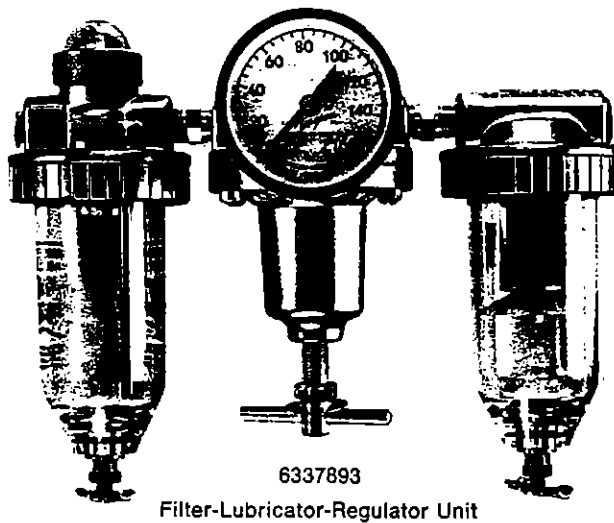

6337893
Filter-Lubricator-Regulator Unit



© 1988

USDA APPROVED

BEST & DONOVAN

5570 Creek Road, Cincinnati, OH 45242, USA

TOLL FREE: 1-800-553-2378
 TELEPHONE: (513) 791-9180
 TELEX: 275-189
 CABLE: WEPCO
 FAX: 513-791-0925