



High quality components ...



...in a sturdy stainless steel cabinet

Main characteristics

- Capacity: 70 kg/24 h flake ice chipped type
- Production of flake ice chipped type with $-0,5\text{ }^{\circ}\text{C}$ from drinking water or demineralized water - Standard- or MicroIce
- including ice storage bin with automatic switch-off
- compact design - fitted installation or under counter
- Designed for continuous operation - 24 hours - 7 days a week
- Hygienic Design: Closed watersystem - protected against contamination by external influences
- Environmental friendly technology - No moving parts in the refrigeration circuit of the evaporator- no refrigerant leakage



StandardIce



MicroIce

Dimensions and connections



- A operating switch
- C ice discharge
- D electr. connection
- E water supply
- F water drain

provided by customer:
 water filter
 stop cock
 electr. protection
 waste water connection (contactless)

Technical Data

ZBE 70-35 20°C	
70 kg/24 h nominal capacity at	20 °C air temperature and 15 °C water temperature
dimensions (L x W x H)	46 cm x 60 cm x 91 cm
weight	70 kg
cabinet	inside / outside stainless steel 1.4301
storage capacity	35 kg
insulation, PU foaming	40 mm
electricity	0,4 kW
power consumption	2,5 A
current consumption	
provided by customer	1/N/PE ~ 230V 50 Hz
electric supply	16 A
fuse, slow-blow	1,5 mm ²
cable cross sectionCu	
water	
supply / drain	3/4 " / 14 mm
provided by customer	
pressure	1 - 5 bar
quality	drinking water
pH-value	7,2 - 9,5 pH
hardness	6 - 14 °dH
temperature	100 - 250 mg CaCO ₃ /l 5 °C - 30 °C
ambient temperature	7 °C - 42 °C
condenser	air cooled
air flow	230 m ³ /h
heat emission	0,42 kW
refrigerant R404A	0,6 kg
compressor	fully hermetic
refrigerating capacity	0,32 kW
evaporation temperature	-12 °C
condensation temperature	30 °C
noise level	45 dBA (3 m)

Subject to technical modifications. In case of deviations please contact us.

Scope of supply

The ZIEGRA ice machine will be delivered according to CE standards and ready for connection to water and electricity.

ZIEGRA quality and reliability

- high pressure pressostat
- water supply control
- Storage thermostat -
to switch-off the machine when ice storage
is full and automatic restart after ice
removal
- Motor protection -
for the compressor

Included accessories

- Connecting cable 5 m
- Flexible hose water supply 2 m
- Water drain hose 2 m
- PE ice shovel

Options

- For connection to cooling water

Consumption cooling water:

- ZBE 30-10 and 70-35: 20 l/h
- ZBE 110-35: 50 l/h

E: water supply (ice production)

F: water discharge (e.g. automatic water drain)

O: cooling water supply

P: cooling water return or drainage, resp.

- Special voltage

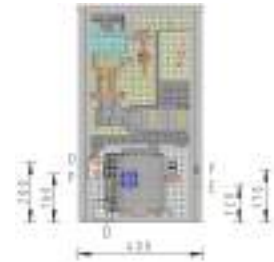

Connections for watercooled model ZBE 30-10

Accessories

- HygienePlus: water drainage, flushing system, or flushing incl. disinfection
- Cartridge Water Filter reduces lime scale and germs
- UV sterilization
- Support, wall brackets, or similar
- Melt water pump, leak water sensor and leak water tray
- additional separate operating switch
- timer for 7 days
- Restart delay
- protection against overvoltage and undervoltage
- Spare parts available for minimum for 15 years



HygienePlus function diagram



Cartridge waterfilter 40

Technical details: please see respective machine specification. With pleasure we submit to you any further information, also regarding your special requirements